

FLOWTOYS MODULAR SYSTEM - COMPONENTS



FLOWLIGHT-FS: World's most revolutionary LED glowstick. Beautifully sculpted polycarbonate shell refracts full spectrum LEDs. 40 adjustable modes with many bright and beautiful color and pattern options, kinetic awareness, accelerometer response, battery and charge level indicators and more. 1 rechargeable AAA provides 3-27 hours runtime. Connect as many as you like to fill your tubes with lights.



CAPSULE 2: Amazing capsule light with over 60 adjustable modes, up to 60 programmable modes, wireless connectivity, USB rechargeable, custom high-temp super bright LEDs, adjustable brightness, accelerometer, motion responsive modes, USB firmware updateable with more features to come.



CAPSULE LINK: Tiny but tough, this link fits inside leash-ports of 2 capsules to link them securely inside tubes. Leaves both buttons accessible.



1" CLEAR TUBES: Highest quality polycarbonate extrusion, transparent yet virtually bulletproof, connects to caps and connectors via snap-button holes. Available in a variety of interchangeable lengths for instant reconfiguration.



TUBE CONNECTOR: New ultra secure and snug 3D-printed connectors with a rigid carbon fiber core and integrated snap buttons that securely connect 2 tubes. Plus its highly-engineered structural design looks so cool ...



CORD CONNECTORS & LEASHES: Cord connectors enable a strong and reliable connection between your flowtoys tubes and leashcord. Screw holes align with holes in tubing for a very secure connection. Features unique anti-pinch tapered top. Used with poi, chucks and darts.



FLOWCAP & ADAPTORS: Thick, soft, durable silicone body. Inner polycarbonate snap-cap buttons snap securely onto tubes and release with a firm twist. Built-in button compatible with capsule lights; connects to flowlights and vision core with adaptors.



POD SHELL: Beautiful, thick, super-soft and durable silicone, built-in button compatible with capsule lights, strategic internal petal-ribs provide structure and focus mass at the bottom for great rotational inertia. Possible to connect to flowlights, but not recommended. **Pod shells attach to tubes with a friction fit - please read instructions and use caution.**



FLOWMASS: These translucent crystalline-looking weights add more inertia to your flow and optimize the balance of your flowtoy. They can be added to crystal cases and flowtoys 1" tubing. Add two or more if you like your tools heavy!



KNOB-LEASH: Adjustable integrated leash with knob handle and minimal hardware. Highest quality for durability, affordability, comfort & endless hours of fun-filled flow!



LINKED CORD CONNECTOR: Two cord connectors linked by a user-adjustable cord that forms a flexible connection between 2 tubes. Allows you to create chucks, tri-sectionals, cubes, tetrahedrons, flails and more.

More modular system components, details and info available on www.flowtoys.com/parts



Modular System Guide

features
operating instructions
troubleshooting
inspiration

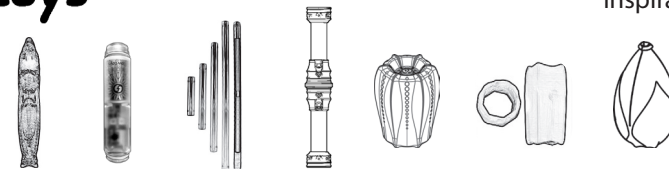

high performance modular system - endless possibilities for flow

Combining versatile flowtoys LED light units – the flowlight and the capsule light – and a series of click-in caps, screw connectors and tubes that are interchangeable, the modular system enables the creation of almost any illuminated prop imaginable.

Gone are the days of wondering how to check in our 5' staffs for travel, or deciding which flowtoys to bring to an event. Now with just a few lights, tubes, caps, and various housings, you can have 4' double staffs that transform into a contact staff, a couple of 3' staffs, poi, chucks and more, and everything fits in a backpack!

The world just became a little more awesome for us, because of the versatility, creativity and fun the Flowtoys Modular System enables. We hope that it will bring more flow and more awesome to your life!

QUICK START GUIDE: THINGS TO KNOW BEFORE YOU FLOW

1. Do not use glowsticks or WD-40 with tubing. While polycarbonate is very strong, it breaks down in the presence of certain esters, including those produced by chemical glowsticks, mineral spirits and WD-40. Do NOT put chemical glowsticks into the tubes, otherwise they can become brittle and shatter. We recommend lubricating the ends of your tubes with a touch of petroleum jelly.

2. Be careful when using your flowtoys in the presence of sand or grit!

Sand and grit can get inside your caps and connectors and make them difficult to use. If you're using flowtoys in a sandy area, blow out/clean your caps and connectors of sand before attaching them to the tubing. If your caps and tubes feel gritty, clean them and apply a bit of vaseline for lubrication.

3. Make sure all caps and connectors are fully secured before use! Check that the buttons in your caps and connectors are fully clicked into the holes of the tubes.

4. Cleaning your flowtoys. If your flowcaps, pod shells, crystal cases or flowmass get dirty after hours of practice in the park, flowing in the forest or rockin' it on a dancefloor, clean them with soap and warm water, or put them in the wash with your laundry: air-dry, no heat!

FOREVER FLOW LIFETIME WARRANTY

Flowtoys are designed to last you a lifetime, but nothing is indestructible, so we provide this warranty to enable you to freely find your flow*.

If you manage to break a flowtoys product, we offer free replacements on defective or non-working parts due to intended use, and

50% credit for products in any condition at any time. Capsule battery depletion is normal wear & tear and covered for free in first 2 years and half-price/capsule after.

If you need warranty support, please contact us at support@flowtoys.com.

* Please check flowtoys.com for full warranty details.

Flowtoys reserves the right to refuse coverage to anyone abusing this warranty. Please contact us before sending in your product, or it may be returned to sender.

FLOWTOYS MODULAR SYSTEM - INSTRUCTIONS

INSTRUCTIONS FOR LIGHTS

Modular system props are compatible with both flowlights and capsule lights - instructions for your lights are included in a separate manual with your prop.

CAPS :: FLOWCAP

Flowcaps are compatible with all flowtoys light engines (flowlights, capsules and vision), and securely click into any flowtoys 1" polycarbonate tubes.

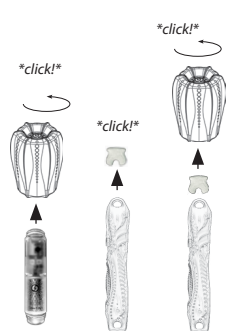

DETACHING/ATTACHING FLOWCAPS TO TUBES:

- To detach, twist firmly to release the buttons and pull.
- To attach, place cap over tube, push and twist until snap-buttons click into the holes.

ATTACHING/DETACHING FLOWLIGHTS TO FLOWCAPS:

- Push the narrow "head" of the flowlight into the adaptor, then insert flowlight+adaptor into the flowcap.
- Twist until the adaptor clicks into place. The sides of the light should align with the buttons in the cap.
- To remove flowlight with adaptor attached, push the center of the cap while twisting the light.
- To leave adaptor in the cap, pull light out while gripping the cap.

ATTACHING CAPSULES TO FLOWCAPS: Insert capsule into flowcap, button side in. Twist and push until it settles. The seams of the capsule must be aligned with the buttons inside the cap for it to fit in the tube.

CAPS :: POD SHELL

Pod shells are intended for use with capsule lights only. Can be used as caps for staff ends. Pod shells provide great rotational inertia for staffs and baton ends, but are not recommended for other props like poi, rope darts, chucks and swinging clubs.

INSERTING CAPSULES INTO POD SHELLS:

Capsules MUST have their C-ring installed before inserting into pod shell. Insert capsule with C-ring into the bottom of the pod shell firmly. Check button for normal operation. If the button is difficult to press, check that the capsule is all the way inside the shell and the C-ring is properly installed on the capsule. Also check that there is not a C-ring already in the pod!

ATTACHING POD SHELL ONTO TUBE:

The pod shell attaches to the tube with a friction fit. Push the pod shell over the tube firmly, ensuring the plastic tube is between the capsule and the silicone tube inside the pod that holds the capsule in place.

Be aware - the tube must be clean and the edge of the silicone that holds the capsule must cover the holes in the tube for a secure fit. Silicone does not stretch out, warp, or relax like other plastics, and as long as it is installed correctly the pod cannot fly off during use. You have been warned. We will not replace parts that go flying due to inadequate connection!

INSTALLING FLOWMASS

Flowmass is slightly tapered with more material on one end— make sure the heavier end is installed at the **far end of your prop, where it counts.**

Adding mass to a crystal case: Thread leash through the mass. Hold leash with one hand and pull the mass down the length of the case with your other hand until mass is in place.

Adding mass to tubes: Apply a little bit of vaseline/petroleum jelly to the inside surface of the mass and slide the tube through it. Ensure there is enough clearance at the top for your flowcaps to click in properly and securely.



CAPSULE LINK :: CONNECT 2 CAPSULE LIGHTS

The capsule link is a little 3D-printed part that can connect 2 capsule lights together.

- Remove the o-rings from the leash-port (battery side) of two capsules.
- Pry open one shell enough to insert the capsule link then reinstall the O-ring.
- Roll the second capsule's O-ring over the first's, then connect the second capsule to the link and roll the O-ring onto it.

It is also possible to install and remove the link by prying and holding the capsule open with the O-rings in place - if you have strong fingers! Only two capsules can be connected - both buttons should face out.



CONNECTING 2 FLOWLIGHTS

If you have two or more flowlights in one tube, you will need to attach the opposite ends of the flowlight to each other for the lights to fit properly, and slide in and out of the tubes conveniently.

Be sure to click them together and apart **sideways** (laterally as shown in the picture), NOT up and down in the direction of the pivot (vertically), as this can cause splitting at the seam and loosen the connection.



TUBE CONNECTORS :: CONNECT 2 TUBES

Tube connectors need some lubrication to avoid getting stuck inside tubes. We pre-lubricate tubes with a tiny bit of vaseline, but you can use almost any greasy substance, e.g. lip balm, coconut oil. Apply some lubricant with your finger or a tissue and wipe the inside of tube - you only need a slight film - wipe away any excess that may hold dirt. Repeat as needed for maintenance (when you feel the connector beginning to bind in the tube).

- To attach, insert the 3D-printed tube connector into the clear tube, line the buttons on the connector with the holes in the clear tube, push and click in to secure.
- To detach, twist the tubes in opposite directions to disengage the buttons from the holes then pull. The buttons are not directional :) but the fit might be very snug.

LINKED CORD CONNECTORS :: Enable a removable, strong and flexible connection between two flowtoys 1" clear tubes.

- Lay the 2 separated cord connectors side-by-side.
- Slide the loop over each connector.
- Pull the connectors to create a secure connection.
- You can shorten the length of your loop by shifting the knot inside the connector. Cut off excess cord, and melt the ends of the knot.
- **To melt:** use a small flame, melt the end of the cord until it reaches the surface of the knot and use a flat metal surface to press the melted end into the sides of the knot, fusing it together and ensuring it cannot come undone! (the side of a lighter works great :)
- **To install:** Use your finger to apply a very small film of petroleum jelly or any other safe grease (lip-balm, hand-lotion, etc.) to the inside of the tube.
- Line up the screw holes on the connector with the holes in your tube. Insert the connector into your lubed tube. Install the 2.5mm hex head screws in the two holes in each tube. Be sure not to strip the threads by over-tightening!!!
- **Note:** Holes are intentionally aligned off-center (towards the cord) to create tension + ensure a snug fit.

